



# JEREMY JAMES

## MARYLEBONE STREET, MARYLEBONE VILLAGE, LONDON W1G



### PRICE

£775,000

### TENURE

Leasehold - 38 Years

### SERVICE CHARGE

£5,000 per annum

### GROUND RENT

£200 per annum

### LOCAL AUTHORITY

City of Westminster

### COUNCIL TAX BAND

F

33 New Cavendish Street  
London,  
W1G 9TS

020 7486 4111  
[jeremyjames@jeremy-james.co.uk](mailto:jeremyjames@jeremy-james.co.uk)



# JEREMY JAMES

## MARYLEBONE STREET, MARYLEBONE VILLAGE, LONDON W1G



### DESCRIPTION

This apartment comprises of entrance hall, reception room, two bedrooms, one bathroom, shower room and sperate kitchen. Both bedrooms have built in wardrobes with the building benefit from a newly refurbished lift and communal gardens.

The building is located on the west side of Marylebone Street close to the junction with Weymouth Street. Bond Street and Baker Street underground stations together with the shopping facilities of Marylebone High Street are within close proximity. The open spaces of Regents Park are also nearby.

### AMENITIES

Top Floor Flat

Passenger Lift

Caretaker

2 Bedrooms

Residents Parking Permit available subject to usual consents

Access Communal Gardens

EPC: D

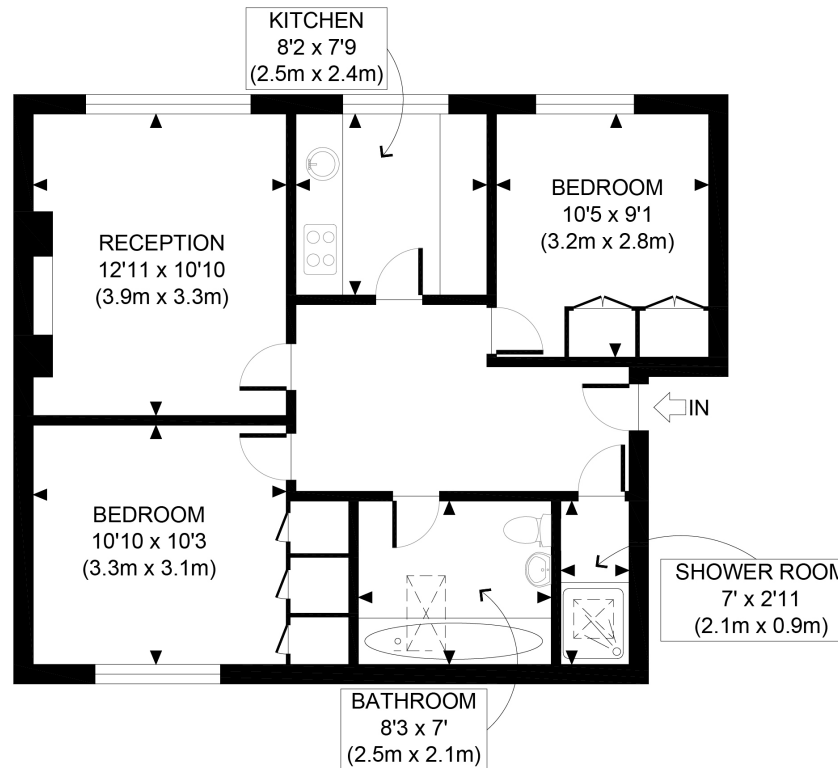

FIFTH FLOOR  
GROSS INTERNAL  
FLOOR AREA 637 SQ FT

APPROX. GROSS INTERNAL FLOOR AREA 637 SQ FT / 59 SQM

Disclaimer: Floor plan measurements are approximate and are for illustrative purposes only. While we do not doubt the floor plan accuracy and completeness, you or your advisors should conduct a careful, independent investigation of the property in respect of monetary valuation



# JEREMY JAMES

MARYLEBONE STREET, MARYLEBONE VILLAGE, LONDON W1G

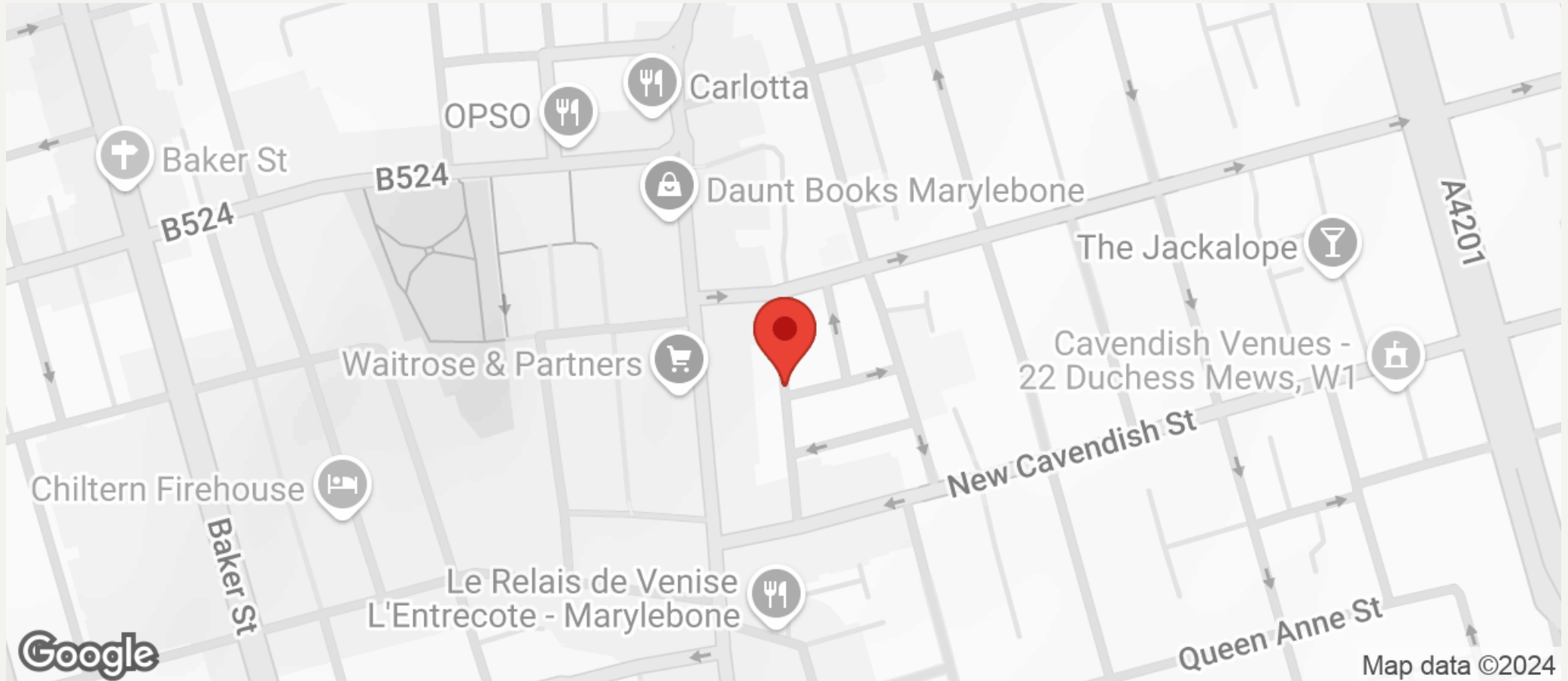

All negotiations are subject to contract. The Agents are not authorised to make or accept any contractual offer unless prior written notification to the contrary has been given on behalf of the client. In no other case whatsoever are the Agents (or any employee or sub-agent) authorised to make or give any representation or warranty on behalf of any party, and whilst information and particulars are given in all good faith intending purchasers and lessees must satisfy themselves independently as to the accuracy of all matters upon which they then intend to rely. Measurements or distances referred to are approximately only. We have not carried out a survey or tested the services, appliances or specific fittings.

33 New Cavendish Street  
London,  
W1G 9TS

020 7486 4111  
jeremyjames@jeremy-james.co.uk