



JEREMY JAMES

WEYMOUTH STREET, MARYLEBONE VILLAGE, W1



PRICE

£650 per week

FURNISHINGS

Part-furnished

DEPOSIT

£3,250

LOCAL AUTHORITY

City of Westminster

COUNCIL TAX BAND

F

33 New Cavendish Street
London,
W1G 9TS

020 7486 4111
jeremyjames@jeremy-james.co.uk



JEREMY JAMES

WEYMOUTH STREET, MARYLEBONE VILLAGE, W1



DESCRIPTION

The accommodation comprises of two double bedrooms, a bathroom and en-suite shower room, an open plan reception room with kitchen with fabulous wooden beams as a feature.

AMENITIES

- Two Double Bedrooms
- Two Bathrooms
- Wooden Floors
- En-Suite Shower Room
- EPC Rating D



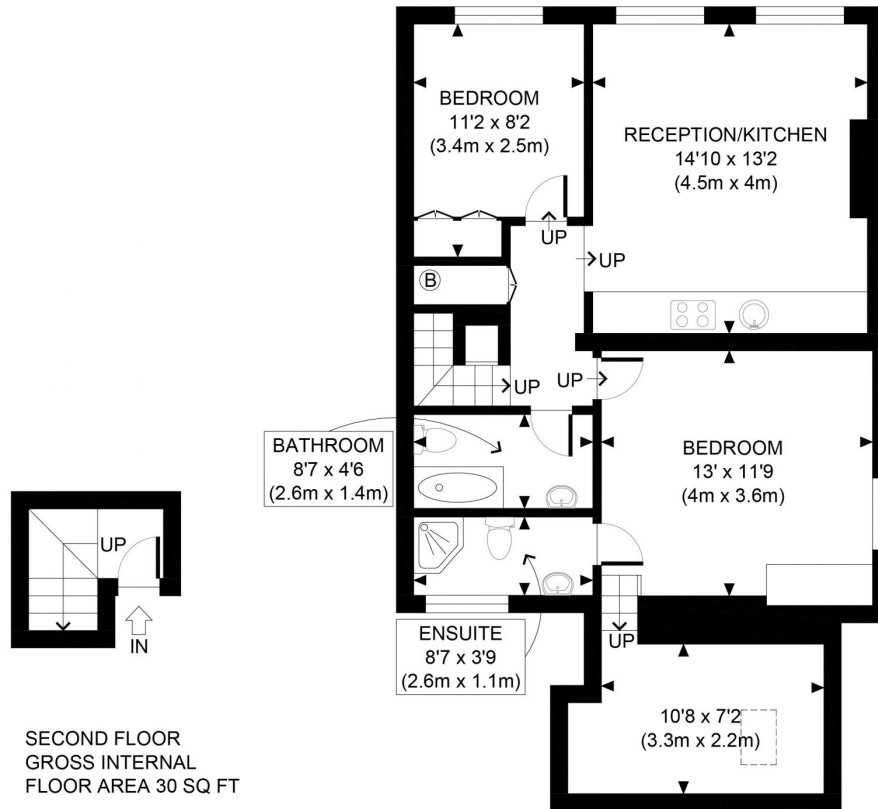

SECOND FLOOR
GROSS INTERNAL
FLOOR AREA 30 SQ FT

THIRD FLOOR
GROSS INTERNAL
FLOOR AREA 709 SQ FT

APPROX. GROSS INTERNAL FLOOR AREA 739 SQ FT / 69 SQM

Ref:

Copyright **photoplan** 

Disclaimer: Floor plan measurements are approximate and are for illustrative purposes only. While we do not doubt the floor plan accuracy and completeness, you or your advisors should conduct a careful, independent investigation of the property in respect of monetary valuation



JEREMY JAMES

WEYMOUTH STREET, MARYLEBONE VILLAGE, W1

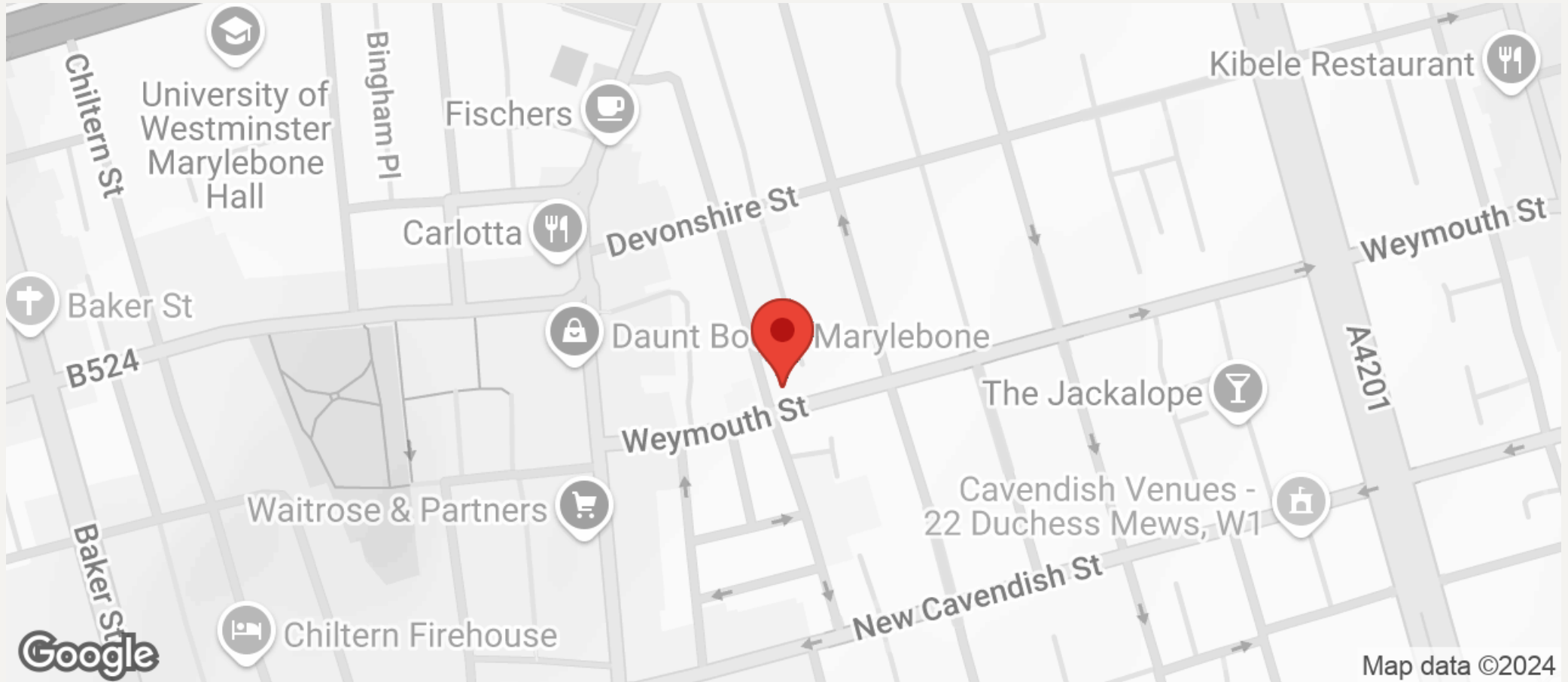

All negotiations are subject to contract. The Agents are not authorised to make or accept any contractual offer unless prior written notification to the contrary has been given on behalf of the client. In no other case whatsoever are the Agents (or any employee or sub-agent) authorised to make or give any representation or warranty on behalf of any party, and whilst information and particulars are given in all good faith intending purchasers and lessees must satisfy themselves independently as to the accuracy of all matters upon which then intend to rely. Measurements or distances referred to are approximately only. We have not carried out a survey or tested the services, appliances or specific fittings.

33 New Cavendish Street
London,
W1G 9TS

020 7486 4111

jeremyjames@jeremy-james.co.uk