



JEREMY JAMES

RIDGMOUNT GARDENS, BLOOMSBURY, WC1E



PRICE

£750 per week

FURNISHINGS

Furnished

DEPOSIT

£3,750

LOCAL AUTHORITY

Camden Council

COUNCIL TAX BAND

F

33 New Cavendish Street
London,
W1G 9TS

020 7486 4111
jeremyjames@jeremy-james.co.uk



JEREMY JAMES

RIDGMOUNT GARDENS, BLOOMSBURY, WC1E



DESCRIPTION

The apartment is located on the second floor and comprises of two double bedrooms, bathroom, sperate kitchen and reception room.

The apartment is ideally positioned in central London, right in the heart of Bloomsbury. The neighbourhood offers a fantastic mix of dining, shopping and cultural spots, all within easy reach. With Goodge Street Underground Station just a short stroll away.

Goodge Street is the nearest Tube station, with Tottenham Court Road also close by. Warren Street, Euston, Russell Square, and King's Cross can all be reached on foot, giving you excellent transport options. Several bus routes run through the area as well, making travel around the city straightforward.

AMENITIES

Two Bedrooms
Second Floor
Bloomsbury
Furnished
EPC: D

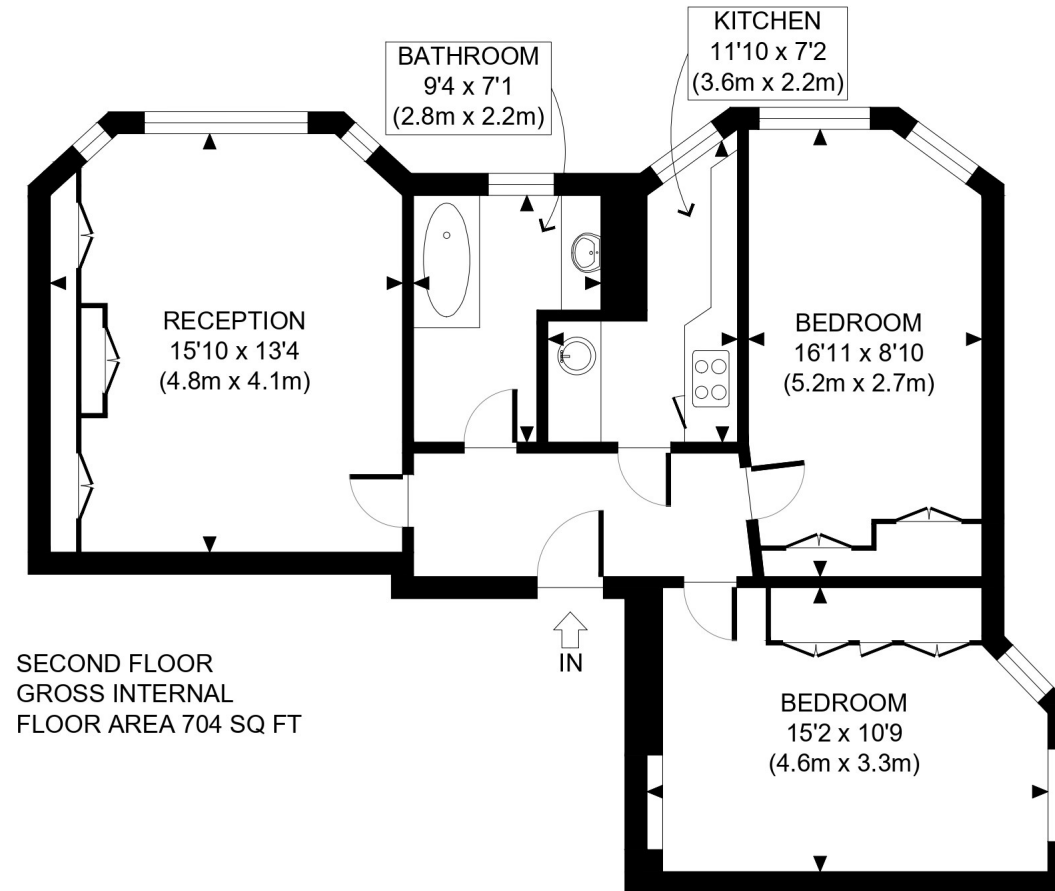

SECOND FLOOR
GROSS INTERNAL
FLOOR AREA 704 SQ FT

APPROX. GROSS INTERNAL FLOOR AREA: 704 SQ FT/ 65 SQM



PROPERTY PHOTO PLANS.CO.UK
ONE STOP SHOP FOR PROPERTY MARKETING

This plan is for illustrative purposes only and should be used as such by any prospective client. Whilst every attempt has been made to ensure the accuracy of the Floor Plan contained here, measurements of the doors, windows, rooms and any other items are approximate and no responsibility is taken for any errors, omissions, or misstatement. The services, systems and appliances shown have not been tested and no guarantee as to the operability or efficiency can be given.



JEREMY JAMES

RIDGMOUNT GARDENS, BLOOMSBURY, WC1E



All negotiations are subject to contract. The Agents are not authorised to make or accept any contractual offer unless prior written notification to the contrary has been given on behalf of the client. In no other case whatsoever are the Agents (or any employee or sub-agent) authorised to make or give any representation or warranty on behalf of any party, and whilst information and particulars are given in all good faith intending purchasers and lessees must satisfy themselves independently as to the accuracy of all matters upon which then intend to rely. Measurements or distances referred to are approximately only. We have not carried out a survey or tested the services, appliances or specific fittings.

33 New Cavendish Street
London,
W1G 9TS

020 7486 4111

jeremyjames@jeremy-james.co.uk