



JEREMY JAMES

MARYLEBONE STREET, MARYLEBONE VILLAGE, LONDON W1G



PRICE

£950 per week

FURNISHINGS

Furnished/Unfurnished

DEPOSIT

£4,750

LOCAL AUTHORITY

City of Westminster

COUNCIL TAX BAND

F

33 New Cavendish Street
London,
W1G 9TS

020 7486 4111
jeremyjames@jeremy-james.co.uk



JEREMY JAMES

MARYLEBONE STREET, MARYLEBONE VILLAGE, LONDON W1G



DESCRIPTION

This two-bedroom apartment features an entrance hall, a reception room, two spacious double bedrooms, a bathroom, and a separate kitchen. Both the bathroom and kitchen have been recently renovated to a high standard. The building offers access to communal gardens and a day porter.

Maybury Court is situated on Marylebone High Street, just moments from its excellent shopping amenities. Bond Street and Baker Street underground stations are within easy reach, and the open green spaces of Regent's Park are also nearby.

AMENITIES

2 Bedrooms

Newly Refurbished

Moments from Marylebone High Street

Day Porter

Communal Garden

EPC: C

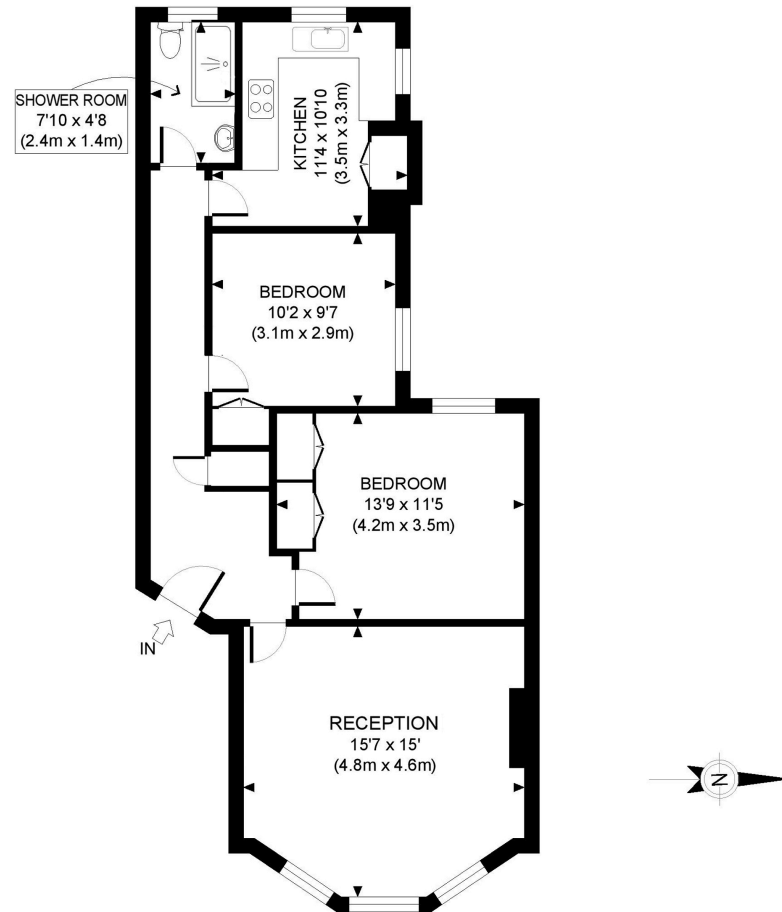

RAISED GROUND FLOOR
GROSS INTERNAL
FLOOR AREA 751 SQ FT

APPROX. GROSS INTERNAL FLOOR AREA: 751 SQ FT/ 70 SQM

PROPERTY PHOTO PLANS.COUK
ONE STOP SHOP FOR PROPERTY MARKETING

This plan is for illustrative purposes only and should be used as such by any prospective client. Whilst every attempt has been made to ensure the accuracy of the Floor Plan contained here, measurements of the doors, windows, rooms and any other items are approximate and no responsibility is taken for any errors, omissions, or misstatement. The services, systems and appliances shown have not been tested and no guarantee as to the operability or efficiency can be given.



JEREMY JAMES

MARYLEBONE STREET, MARYLEBONE VILLAGE, LONDON W1G



All negotiations are subject to contract. The Agents are not authorised to make or accept any contractual offer unless prior written notification to the contrary has been given on behalf of the client. In no other case whatsoever are the Agents (or any employee or sub-agent) authorised to make or give any representation or warranty on behalf of any party, and whilst information and particulars are given in all good faith intending purchasers and lessees must satisfy themselves independently as to the accuracy of all matters upon which they intend to rely. Measurements or distances referred to are approximately only. We have not carried out a survey or tested the services, appliances or specific fittings.

33 New Cavendish Street
London,
W1G 9TS

020 7486 4111

jeremyjames@jeremy-james.co.uk